

EXHIBITOR AGREEMENT

Public Health Services & Systems Research Keeneland Conference

April 12-14, 2011

Sponsored by



&



EXHIBITOR CONTACT INFORMATION:

LAST NAME _____ FIRST _____ MI _____
TITLE _____ DEGREES _____
COMPANY _____
DEPT. _____
ADD. 1 _____
ADD. 2 _____
CITY _____ STATE _____ ZIP _____
CELL # _____ OFFICE # _____
EMAIL _____

CONTACT:

Send completed form to:
UK College of Public Health
c/o Kara Richardson
121 Washington Avenue, Ste. 212
Lexington, KY 40536-0003
Email: Kara.Richardson@uky.edu
Direct: 859.218.2289
Fax: 859.257.3748
Forms must be received by **March 11, 2011**.
Thanks to the generous support of RWJF, there is NO registration fee.

HOW YOU WOULD LIKE TO HAVE YOUR NAME PRINTED ON YOUR BADGE? (Including Degrees)

EXHIBITION HOURS, FURNITURE, AND LOCATION:

HOURS:

Tuesday • 04.12.11

Exhibitor Move-In 8:00 a.m. to 11:00 a.m.
Exhibit Area Open* 12:00 p.m. to 7:00 p.m.

Wednesday • 04.13.11

Exhibit Area Open* 8:00 a.m. to 7:00 p.m.

Thursday • 04.14.11

Exhibit Area Open* 8:00 a.m. to 9:15 a.m.
Exhibitor Move-Out 9:15 a.m. to 12:30 p.m.

*Exhibits **DO NOT** have to be manned during the entire conference.
But, exhibitors should refer to the agenda for break times when attendees will be likely to visit the exhibit area.

FURNISHINGS:

- ___ Table (8' table, with black skirt. Enter number of tables needed.)
- ___ Chairs (Enter number of chairs needed.)
- ___ Electrical Outlets (Enter number of outlets needed.)
- ___ Wireless Internet Access (Enter the number of logins needed.)

SHIPPING:

Exhibitors are responsible for coordinating the shipping, handling, installing, and dismantling of their own materials. In addition to the labels provided by the carrier, please attach a copy of the **show-site label** provided:

LEXPO Exhibition Company

C/O Keeneland Conference

430 W. Vine Street, Manchester Street Dock

Lexington, KY 40507

SOCIAL MEDIA:

Exhibitors are encouraged to use the social media outlet of their choice before, during, and after the conference. Follow the conference online at www.twitter.com/keenelandconf and use #KC11 when posting.

LOCATION:

The exhibit area will be located in the Thoroughbred Prefunction Space at the Lexington Convention Center. Scientific sessions will take place in the Thoroughbred (TB) Meeting Rooms 1-8.

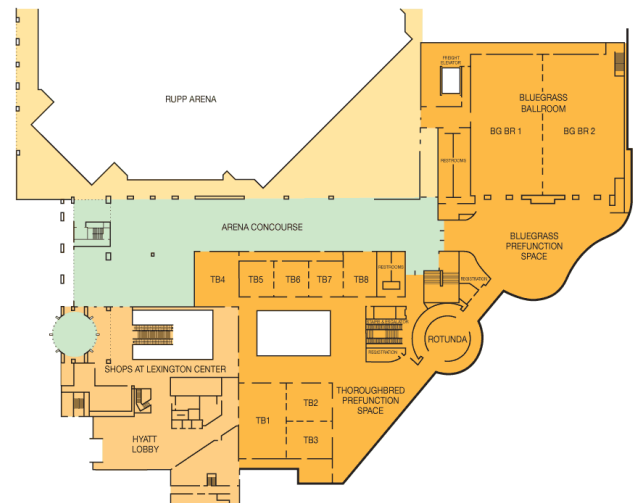

RELEASE:

Conference sessions will be recorded. By signing this form, you agree to allow The Center for PHSSR and its affiliates to use any audio/video recordings and photographs of you and your exhibit materials on its website and in any print materials.

Signature

Date

Direct to Show Site

SHIP TO:



**LEXINGTON
CENTER**

**LEXPO Exhibition Company
430 W. Vine St.
Manchester Street Dock
Lexington, KY 40507**

**NO SHIPMENTS
ACCEPTED BEFORE:
MONDAY, APRIL 11, 2011**

FOR THE:



April 12-14, 2011

EXHIBITOR:

BOX _____ OF _____

----- Cut along line and tape label to shipment -----

Direct to Show Site

SHIP TO:



**LEXINGTON
CENTER**

**LEXPO Exhibition Company
430 W. Vine St.
Manchester Street Dock
Lexington, KY 40507**

**NO SHIPMENTS
ACCEPTED BEFORE:
MONDAY, APRIL 11, 2011**

FOR THE:



April 12-14, 2011

EXHIBITOR:

BOX _____ OF _____

----- Cut along line and tape label to shipment -----

The above labels are provided for your convenience.
Place one on each piece shipped to ensure proper delivery to **SHOW-SITE**.
If more labels are needed, copies are acceptable.